

TQA1 Entrance – Overview

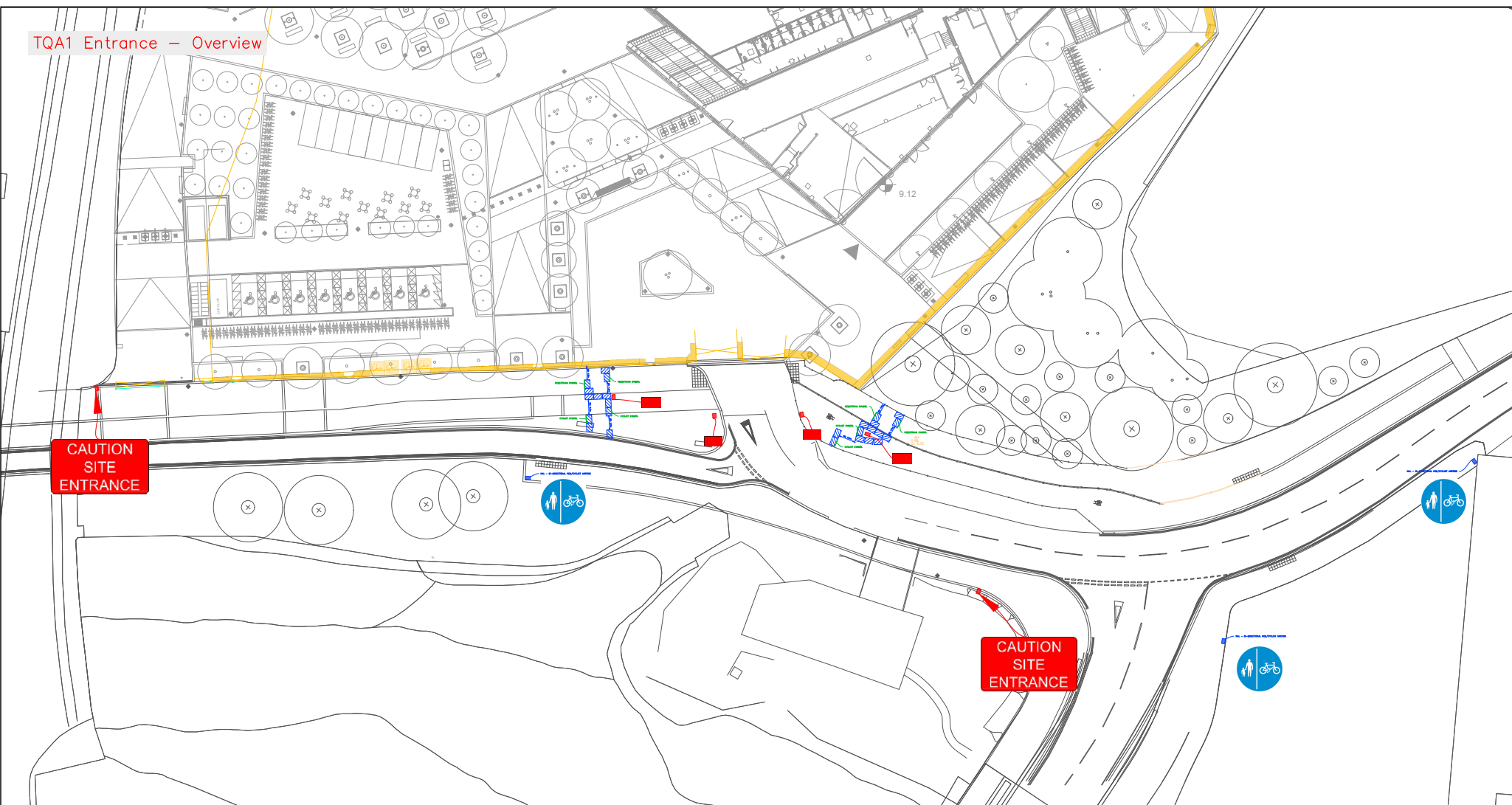

Junction of Feeder Road/Albert Road

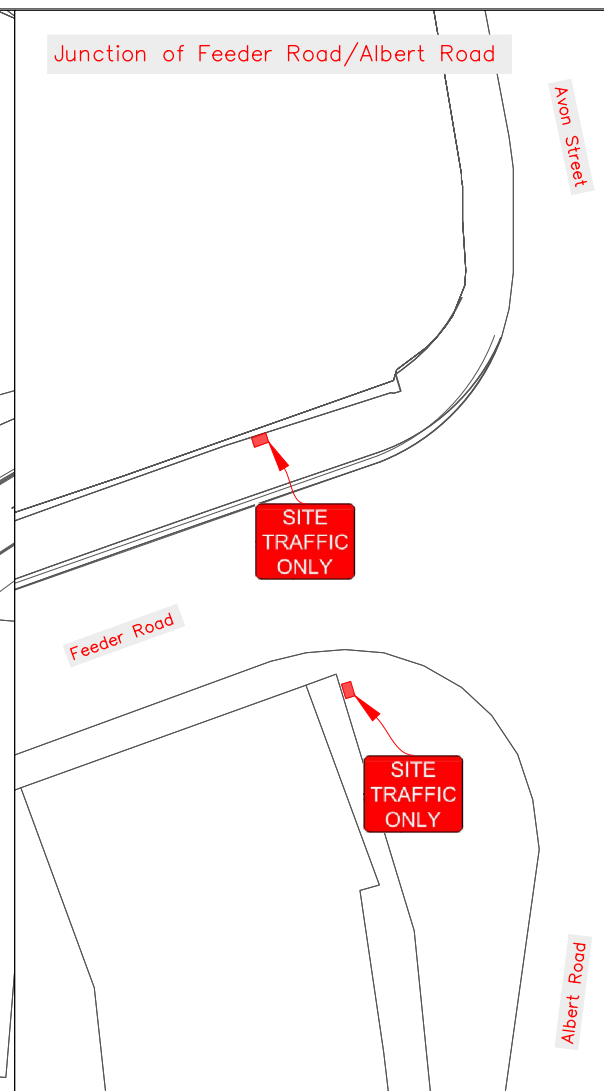

This Drawing Is The Property Of Sir Robert McAlpine Ltd And No Reproduction Thereof May Be Made In Whole Or In Part Without Permission

NOTES:

1. TQA1 Site Entrance gates and all vehicles attending site are managed by qualified traffic marshals.
2. Concrete Lego blocks used to form chicane elements. Block sizes shown are 1.2m x 0.8m x 0.8m.
3. 'Pedestrian/Cyclist Symbol' notation refers to our intent of adhesive stickers to a face of a Lego chicane block, in order to provide direction through each chicane.
4. S278 Specification Works to be completed by the end of the Project.

TQA1 Entrance – Detailed View

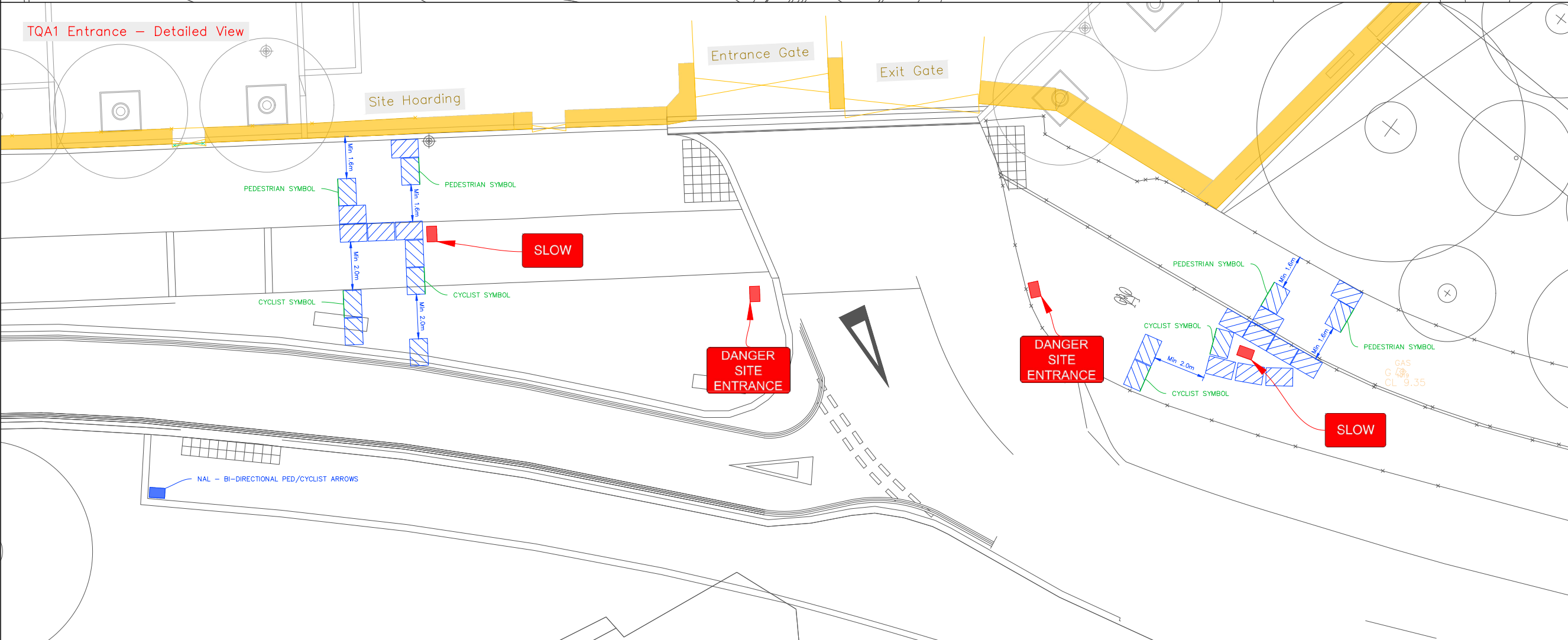

Rev.	Description	By	Date	Chk'd	Auth

Current Issue Status
S2 - FOR INFORMATION P01

Scale	Current Issue Details	Checked	Approved
NTS	Drawn	OR	Date
Sheet Size	Date	Date	Date

Current Revision Notes

Sir Robert McALPINE
 100 Park Avenue
 Aztec West
 Bristol
 BS32 4TT

ENGINEERING DEPARTMENT
 www.srm.com

Project
TQA1

Drawing Title
**TQA1 ENTRANCE
 GENERAL ARRANGEMENT**

Rev.	Description